



aarvee associates

architects engineers & consultants pvt. ltd.

AN ISO 9001:2015 CERTIFIED COMPANY



ARCHITECTS | ENGINEERS | CONSULTANTS

About Us

Aarvee Associates Architects Engineers & Consultants Pvt Ltd is a premier ISO 9001:2015 certified multi-sectorial Infrastructure consultancy established in 1989 in Hyderabad, India. Aarvee has a global presence with subsidiary companies in Australia and United Kingdom and branch offices in Tanzania, Kenya, Ethiopia, Mozambique, Uganda and Kazakistan. Within India, we have branch offices in Ahmedabad, Bengaluru, Bhubaneshwar and New Delhi.

We have successfully carried out over 2,000 assignments in India, Australia, Bangladesh, Botswana, DR Congo, Djibouti, Ethiopia, Gabon, Honduras, Kazakistan, Kenya, Mozambique, Nigeria, PNG, Rwanda, South Africa, Sudan, Sri Lanka, Tanzania, Uganda and Zambia. We continue to work on projects funded by various international agencies, including the World Bank, the Asian Development Bank (ADB), the Japan International Cooperation Agency (JICA), the African Development Bank (AfDB), the New Development Bank, the Asian Infrastructure Investment Bank and the EXIM Bank of India.

With over 3,000 highly qualified and experienced staff, our expertise spans over all the major civil engineering disciplines and infrastructure sectors. We also have a full-fledged material investigation laboratory and excellent in-house survey capabilities, which add considerable value to our work.

With a single-minded focus on exceeding client expectations, our work is characterized by unwavering commitment, utmost reliability, exceptional quality, and on-time delivery.



& HIGHWAYS BRIDGES

A modern and efficient road network is an essential component of a nation's infrastructure, and an important prerequisite for sustained economic growth. Many countries have been making great strides in improving their highway infrastructure, and we have been participating in different stages of this transformative process for many years. In the last twenty years, we have provided consultancy services in more than 150 highways projects with a total road length of over 20,000km in India, Bangladesh, Australia, East African Countries such as Djibouti, Ethiopia, Kenya, Mozambique, Rwanda, Tanzania, Uganda and Zambia.

Services

- Feasibility Studies (FS) and Detailed Engineering Services
- Construction Supervision (CS)
- Independent Engineer's Services (IE)
- Pre-bid and Detailed Engineering Services for PPP/BOT/EPC Projects
- Lenders Engineering Services (LIE)
- Authority Engineer's Services (AE)
- Detailed Project Reports (DPR)

Key Projects

- Detailed Engineering Services for the Hyderabad Outer Ring Road, Telangana, India
- DPR for work of Construction of Two Interchanges at Amra Marg with NH-4B near Gavhan Phata and at Karal Junction with NH-4B and SH-54 in Mumbai in Maharashtra, India
- DPR for development of Economic Corridors, Inter Corridors and Feeder Routes to improve the efficiency of freight movement in India under Bharatmala Pariyojana for Surat – Nashik – Ahmednagar – Solapur – Akalkot – KN/TS Border (750 km) section under Surat - Chennai Corridor, India
- DPR for construction of 6 lane Cable Stayed bridge across Mir Alam tank connecting Bangalore National Highway to Chintelmet Road, Telangana, India
- Improvement-Development and Management of New Indian Bridge Management System for all type of bridge structures on National Highways in the Country, India
- AE for Six Laning of Km. 192.000 to Km. 198.000 between Vadodara–Surat section of NH-8 including construction of a new four lane Extra Dosed Bridge across river Narmada in the State of Gujarat, India
- IE services for 4-laning of Beawar-Pali-Pindwara on of NH-14 (244km) under NHDP Phase-III on Design, Build, Operate and Transfer (Toll) basis in Rajasthan, India

HIGHWAYS & BRIDGES

Services

Feasibility Studies and Detailed Engineering Services

- Topographic Surveys
- Traffic Surveys & Axle Load Spectrum Studies
- Traffic Demand Forecasting & Capacity Analysis
- Pavement Condition Studies & Overlay Designs
- Flexible and Rigid Pavement Design
- Safety Audit
- Highway Geometric Design
- Hydrological and Drainage Studies
- Design of Culverts, Bridges and Protection Works
- Bridge Rehabilitation Works
- Study of Options and Value Engineering
- Detailed Costing and Quantity Estimation
- Strategic Options and Prioritization Studies
- Economic & Financial Analysis
- Construction Programs & Method Statements
- Safety and Traffic Management Plans
- Preparation of Bid Documents & Evaluation of Bids
- Environmental Impact Assessment Studies
- Socio-Economic and Rehabilitation & Resettlement Studies
- Obtaining Environmental and Other Clearances from Statutory Bodies

Construction Supervision and IE/AE/PMC

- Design Review
- Quality Assurance
- Contract Administration
- Operation and Maintenance
- Safety & Traffic Management

PPP/BOT/EPC Projects

- Pre-bid Services
- Traffic Validation and Revenue Forecasts
- Preliminary Design & Value Engineering
- Financial Analysis
- Detailed Engineering Services
- Project Management Services
- Lender's Engineering Services
- Safety Audits

Selected Projects

FS and DPR for 4/6-laning of Tirupati - Tiruthani - Chennai Section (138 km) of NH-205 on BOT Basis under NHDP Phase III, Andhra Pradesh and Tamil Nadu, India.

FS and DPR for 4/6-laning of Panikoili - Keonjhar - Rimuli Section (166 km) of NH-215 on BOT basis under NHDP Phase III, Odisha, India.

FS for 6-laning of Srikakulam – Visakhapatnam Section (95 km) of NH-5 under NHDP Phase-V (Lot 3), Andhra Pradesh, India.

DPR for 2-lane with Paved Shoulders of Wardha - Sangli Section of MSH3 (480 km), Maharashtra, India.

FS for 4-Lane 6 km length Bridge Over River Ganga, near Sahibganj in Jharkhand connecting NH-80 to NH-81 in Bihar, India.

FS and DPR for Rehabilitation and Up-gradation of Tuljapur – Buttibori section of NH-361 and Sangli - Solapur section (727 km) of NH-166, Maharashtra, India.

FS and DPR for Elevated Corridor and Widening of the existing road to 6-lane and 2-lane service roads on either side from Balanagar Junction to ORR Junction (15 km) on Hyderabad - Narsapur - Medak Road, Telangana, India.

DPR for New Khambataki Tunnel (1400 m) in Pune - Satara Section (6 km) of NH-4, Maharashtra, India.

CS of World Bank aided Gujarat State Highway Project Phase-II (389 km), Gujarat, India.

CS of World Bank aided Karnataka State Highway Improvement Project, Phase-I (664 km), Karnataka, India.

IE for Jaipur - Deoli Section of NH-12 (148 km) under NHDP Phase-III, Rajasthan, India.

CS Services for Rehabilitation and Upgradation to 2-Lane with Paved Shoulders for selected sections of NH-69A and NH-26B including the Ring Road and Connecting Roads in Chhindwara Town (418 km), in the state of Madhya Pradesh and Maharashtra, India.

AE for Supervision of (7 km) 6-laning between Vadodara - Surat section of NH-8 including a new 4-lane Extra Dosed Bridge (1 km) across River Narmada on EPC contract mode in Gujarat, India.

FS and DPR for construction of new 4-lane Bridge (3 km) over River Ganga at downstream of Farakka Barrage including approaches connecting Farakka – Raiganj Section of NH-31, West Bengal, India.

Selected Projects

CS of Design and Build Contract for Mukono - Kalagi - Kayunga and Bukoloto - Njeru Road (95.2 km), **Uganda**

CS of Upgrading of Usagara - Kisesa (16 Km.) to Bitumen Standard, **Tanzania**

CS of Durbete – Kunzila – Gelago – Metema, Lot 1: Durbete – Kunzila – Shahura – Fingit Design and Build Road Project, **Ethiopia**

CS for upgrading of Sumbawanga - Namanyere - Mpanda Road to Bitumen Standard : Package 4: Sitalike - Mpanda Section (36.90 Km.), **Tanzania**

CS for Uganda National Roads Authority (UNRA) Project “Design and Build of Mbarara - Kikagati - Murongo Bridge Road”, **Uganda**

CS of Upgrading of Tabora - Koga - Mpanda Road (354 Km.) to Bitumen Standard; Lot-1: Tabora - Sikonge (Usesula) section (30 Km.), **Tanzania**

CS for Mizan Dima - Boma Road Upgrading Project Contract-1 - 91.60 Km - World Bank Funded Project, **Ethiopia**

CS and DPR for Rehabilitation of Road N280/N281 between Tica, Buzi and Nova Sofala in Sofala Province – EXIM Bank of India Funded Project, **Mozambique**

CS for Detailed Feasibility Study and preparation of Procurement documents for Adama – Awash – Meisso – Dire Dawa Public Private Partnership (PPP) Road project, **Ethiopia**

CS for the Preparation of Concept Design for Bahir Dar Abay River Bridge Project (Abay is the local name for river Blue Nile), **Ethiopia**

CS for the FS an Assignment of the Luangwa Bridge across the Luangwa River on the Great East Road (T4) in Eastern Province, **Zambia**

CS for Supervision of Rehabilitation, Improvement and Maintenance of Rural Roads in Zambézia Province; Funded by World Bank, **Mozambique**

CS for Monitoring Supervision of Rehabilitation and Maintenance of Roads N10&N1 between Quelimane to Nicoadala (37km) and Nicoadala to Namacurra (33km) in Zambezia Province (70km); RFP N° 11/DG-ANE/352/2019; Funded by World Bank, **Mozambique**

CS of Kenol-Sagana-Marua Highway Improvement Project Lot 2 - Dualling of Sagana-Marua (A2) road-36kms, **Kenya**

PMC for Ngong Kiserian Isinya and Kajiado Imaroro Roads, **Kenya**

CS for Design Check Malhemele and Guava Network – Lot 2; Greater Maputo Water Supply Expansion Project; (GWSP); Contract No.: FIPAG/GMWSP/CON-09A/13; Funded by World Bank, **Kenya**

CS of Malhemele and Guava Network – Lot 2; Greater Maputo Water Supply Expansion Project; (GWSP); Contract No.: FIPAG/GMWSP/CON-09B/13; Funded by World Bank. **Kenya**

Consulting Services for Design and Supervision of Rehabilitation and Construction of Distribution Centers and Network, Tete and Moatize, **Mozambique**

DPR for Matanda Irrigation Scheme in Kanungu District, **Uganda**

FS and Detailed Engineering Design for Irrigation Schemes in Lot 3: Pabbo, Rhino Camp-Wadelai, Biiso & Toch under FIEFOC Phase II, **Uganda**

Detailed FS for Matanda/Enengo Irrigation Scheme in Kanungu District, **Uganda**

Key Projects

Six Lane Cable Stayed Bridge across Mir Alam tank



Location	: Telangana, India
Client	: Hyderabad Metropolitan Development Authority (HMDA), Govt. of Telangana
Completion	: Ongoing
Scope of Work	: Detailed Engineering
Salient Features	: Main span of 350m Length with back spans of 155m length. Total length of cable stay portion is 660m. Approach spans are 50m segmental box girder Superstructure is proposed as steel composite girder with precast deck panels and a cast-in- situ stitch. Height of Pylon is 100m and Total Length of Bridge is 2.5km

Jawaharlal Nehru Outer Ring Road

Location	: Jawaharlal Nehru Outer Ring Road
Client	: Hyderabad Growth Corridor Limited, Hyderabad
Completion	: July 2007
Scope of Work	: Detailed Engineering
Salient Features	: The Jawaharlal Nehru Outer Ring Road is India's first 8-lane access controlled expressway with a design speed of 120kmph. The expressway has 8-lane divided carriageway with an emergency lane in each carriageway. There are 7 high capacity interchanges and 25 rotary interchanges on the intersections with the existing/proposed arterial/radial roads. There are 5 major bridges, 45 minor bridges, 140 underpasses, 4 overpasses and 4 ROBs. A 25m wide corridor is reserved to be used as a transport corridor in the future.



Ganga Bridge at Sahebganj



Location	: Jharkhand, India
Client	: National Highways Authority of India (NHAI)
Completion	: June 2016
Scope of Work	: Feasibility Study
Salient Features	: Type of Superstructure: 3 modules of (110+180+110) Extradosed bridge for main span + 40m Precast segmental box girder for approaches Total Length of Bridge(Including approaches): 3.30km

Key Projects

6 Lane Elevated Corridor from Paradise Junction to ORR Junction on Hyderabad – Karimnagar – Ramgundam Road



Location	: Telangana, India
Client	: Roads & Buildings Department (R&B), Govt. of Telangana
Completion	: January 2018
Scope of Work	: Detailed Project Report
Salient Features	: Type of Superstructure: Segmental Box Girder with External Posttensioning Total Length of Elevated Corridor: 11.120km (6 Lane elevated structure) Detailed Project Report for Construction of Elevated corridor at the congested areas & widening of the existing road to Six lane with Two lane Service roads on either side in open areas from Paradise junction to ORR junction on Hyderabad – Karimnagar – Ramagundam road in the State of Telangana

Extra Dosed Bridge Across River Narmada

Location	: Gujarat, India
Client	: National Highways Authority of India
Completion	: June'
Scope of Work	: Authority Engineer Services
Salient Features	: This is a 6km long 6-lane highway which has one Major Bridge of 1.344km length and Span 1x96m + 8x144m + 1x96m. The Bridge is an extra dosed bridge across river Narmada and is one of the few extra dosed bridges in the country.



Vadodara Kim Expressway (Pkg-1, Pkg-2 & Pkg-3)



Location	: Gujarat, India
Client	: National Highways Authority of India
Completion	: August 2022 (substantial)
Scope of Work	: Independent Engineer Services
Salient Features	: 8 Lane (access controlled) Greenfield Expressway Project of length 86.74km is part of the Delhi - Mumbai Expressway consists of rigid pavement in full length with 4 no. interchanges, 4 no. ROBs, 7 no. major bridges, 29 no. minor bridges, 8 no. flyovers and 107 underpasses. Unique feature of the Project is construction of Wayside Amenities, besides huge truck parking areas, with world class facilities including food plaza, motel, trauma centre with OTs, travel information centre, dormitory, toilet blocks, stores, fuel station and garages, play areas, plush landscaping, helipad etc.,

Key Projects

Extra -Dosed Major Bridge across Sharavathi Backwaters



Location	: Karnataka, India
Client	: MoRTH, Govt. of India
Completion	: Ongoing
Scope of Work	: Authority's Engineer Services
Salient Features	: The total length of the bridge being developed in the back waters of River Sharavathi is 2.125km. Span Arrangement adopted for the Extra dosed portion is 3 x 177m + 2 x 104.5m, for Balanced Cantilever is (6x90m) + (6x 135m) and for the end span near A2 is 35m

Nagpur – Mumbai Super Communication Expressway (Package-6)

Location	: Maharashtra, India
Client	: Maharashtra State Road Development Corporation, Govt. of Maharashtra
Completion	: December 2022
Scope of Work	: Authority Engineer Services
Salient Features	: 6 Lane (access controlled) Greenfield Expressway Project of length 36.10km is part of the Nagpur - Mumbai super communication Expressway consists of rigid pavement in full length with 1 no. interchange, 4 no. VOPs, 31 Underpasses, 2 no. POPs, 1 no. major bridges and 17 no. minor bridges. The Project includes provision of noise barriers at selected locations, construction of 1 no. Wayside Amenity with facilities including food plaza, toilet blocks, stores, fuel station etc.



Okha – Beyt Dwarka Signature Bridge



Location	: Gujarat, India
Client	: R&B Dept., Govt. of Gujarat
Completion	: Ongoing
Scope of Work	: Authority Engineer Services
Salient Features	: This is an iconic cable stayed bridge with curved A-shape pylons of 128.5m with 152 stay cables & a navigation span of 500m connecting Dwarka Mainland with Beyt Dwarka Island. The length of the Project is 4.772km (Approaches: 2.452km & Bridge: 2.320km) This bridge will ease commute of devotees who wish to travel between Dwarka and Beyt Dwarka. Unique feature of the Project includes 2.5m cycle track / pedestrian walkway with roof mounted (of solar panels), cantilever view gallery, decorative lighting, VVIP parking etc.

Key Projects

Gomati - Chauraha - Udaipur Section of NH-8



Location	: Rajasthan, India
Client	: National Highways Authority of India, Ministry of Road Transport & Highways
Completion	: December 2015
Scope of Work	: Independent Engineer
Other Information	: This is a 79.30 km long 4-lane highway Project which includes 1.26 km of elevated Highway and 450 m long 4 lane twin tunnel. The Project includes construction of 4 Flyover, 1 overpass, 2 Major Bridges, 4 Vehicular Underpass, 7 Pedestrian Underpass and 4 Cattle Underpass.

Ahmedabad – Vadodara of NH-8

Location	: Gujarat, India
Client	: National Highways Authority of India (NHAI)
Completion	: Completed/In use
Scope of Work	: Supervision
Other Information	: This is a 102.3 km long 6 lane highway which includes 4 major bridges including 560m long bridge on Mahi river. The Project also includes Operation and Maintenance of 93 km long Expressway (NE-1). The project was completed 27 days ahead of schedule. The Project was awarded “The best Project (Overall)” by NHAI in 2016.

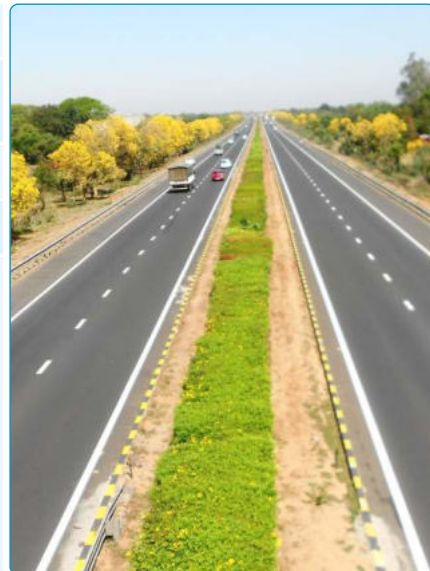

Mizan - Dima - Boma Road Upgrading Project



Location	: Ethiopia
Client	: Ethiopian Road Authority
Scope of Work	: Construction Supervision
Other Information	: World Bank Funded Project. 4-lane divided carriageway in urban sections of length 16 km being executed in a very tough terrain with hostile solid conditions. Project Length: 2 Laning of 91.60 km

Key Projects

Luangwa Bridge on Luangwa River on Great East Road (T4)



Location : Zambia

Client : Zambia Road Authority

Scope of Work : Feasibility Study

Other Information : The Luangwa Bridge carries the Great East Road across the Luangwa River approximately 230 km east of Lusaka City. This cable-stayed bridge was built in 1968 and has a 9.8 m wide steel-reinforced concrete deck, composite with transverse floor beams; two, 42 m high, steel pylons and supported by coiled bridge cable stays. The main span is 222 m with approach spans are of 40 m each. The bridge is currently operational with only one heavy vehicle at a time with a maximum vehicle weight 55 tons traveling at a speed of 30 km/hr.

This Feasibility Study project has following objectives:

- Collection of analysis, designs and drawings of latest rehabilitation as available
- Carryout detailed inspection of the bridge
- Perform assessment of bridge condition and load carrying capacity
- Recommend possible technical solutions for bridge to be able to carry SATCC loading and expected increased traffic.

Kilombero Bridge



Location : Ifakara District, Tanzania

Client : Tanzania National Roads Agency, Tanzania

Completion : Ongoing

Scope of Work : Construction Supervision

Other Information : Consultancy Services for Supervision of Construction of Kilombero Bridge (384 m) and its approach roads (9.142 Km) along Ifakara - Mahenge Trunk Road Section.

& RAIL METRO RAIL

In the face of increasing energy prices, railways has re-emerged as a relatively attractive means to transport both passengers and freight. Growth in this sector has also been fuelled by the growth of the extraction and processing industries, and developments in the power sector. Having planned and designed over 10,000km of railway lines and overseen the development of another 3,000km of railway track from concept to commissioning, we are one of the few wholistic railway consulting firms in India. In addition to civil infrastructure for Metro Rail, Heavy Haul Freight Rail and High-Speed Rail projects in India and overseas, we also have expertise in signalling and tele-communication, overhead electrification and loco and wagon related services.

Services

Passenger, Freight, High Speed and Metro Rail:

Master Planning/Feasibility Studies (FS)/Viability Studies

Detailed Project Reports (DPR)

Pre-bid and Detailed Engineering Services for PPP/BOT/EPC Projects

Project Management Consultancy (PMC) and General Consultancy Services (GC)

Detailed Design - Alignment, Track, Civil Works (Viaducts, Bridges, Stations & Buildings), Signalling & Telecommunication Systems, Electrical & Traction Systems

Loco and Wagon Related Services

Key Projects

DPR and Final Location Survey for 4500km for East Coast, East West and North South Sub-Corridors of DFCCIL, India.

PMC for Mumbai Ahmedabad High Speed Rail Corridor for National High Speed Rail Corporation, India

Final Alignment Design for New High Speed Rail Corridors: Delhi - Varanasi & Lucknow – Ayodhya, Delhi – Amritsar & Sangrur – Chandigarh, and Chennai - Bangalore - Mysuru for NHSRCL, India

Detailed Design, Construction Support and As-built Engineering support for Carmichael Rail Network design of a 200-kilometer-long narrow-gauge rail network, Bravus Mining & Resources, Queensland, Australia

GC for Lucknow Metro Rail Project for Lucknow Metro Rail Corporation, Uttar Pradesh, India

GC for Corridor 3 & 5 (JICA Portion) of Chennai Metro for CMRL, Tamil Nadu, India

Detailed Design Consultancy for Phase II of Chennai Metro for CMRL, Tamil Nadu, India

Technical assistance study for instrumentation of new proposed Vaitarana Bridge and one major bridge with open web steel girder for MRVC, India

FS, Detailed Design, Tendering Services and Construction Supervision for Dual Gauge Railway Line from Bogura to Shahid M. Mansur Ali Station of Bangladesh Railway (EXIM Bank of India Funded)

AIRPORTS

With air travel becoming a key factor for the growth of our economy, it is essential to ramp up airport infrastructure in the country to cater the growing demand in the market. Our multi sectorial expertise enables us to undertake the complex interfaces between city side, air side and terminal infrastructure.

Services

Feasibility Study (FS) / Technoeconomical Feasibility Study

Detailed Project Reports (DPR) / Detailed Design Consultan (DDC)

Project Management (PMC) / Authority's Engineer (AE)

Key Projects

PMC for Development of Operational Area of the New Green Field Airport at Dholera for Dholera International Airport Corporation Limited (DIACL) Gujarat, India

DDC for cargo food court, Gate No:8, Cargo fire tank, Cargo, Landslide road, Cargo compound wall and reconstruction of Roda at gate No:6 Chatrapati Shivaji Maharaj International Airport, Mumbai, Maharashtra, India

Design Services for Hangar for BSF at Swami Vivekananda Airport, Raipur, Chhattisgarh, India

ROPEWAYS

Ropeways are a highly efficient and environmentally friendly mode of transportation, particularly in areas with steep terrain or difficult-to-reach locations. We bring a wealth of multi-sectorial expertise and strategic partnerships to provide comprehensive services for ropeway projects. We offer end-to-end consultancy services to navigate the complexities of ropeway projects and ensure their success and sustainability.

Services

Pre Feasibility / Techno-economic Viability Studies

Feasibility Studies (FS)/Detail Project Report (DPR)

Authority's Engineer (AE) / Construction Supervision (CS)

Feasibility Projects Mention

Key Projects

Pre-feasibility study for Development of Ropeway Projects under Parvatmala Program, 3 projects for Assam and 2 projects for Arunachal Pradesh, India

Pre-feasibility study for Development of Ropeway Projects under Parvatmala Program, 2 projects for Uttar Pradesh and 2 projects for Madhya Pradesh, India

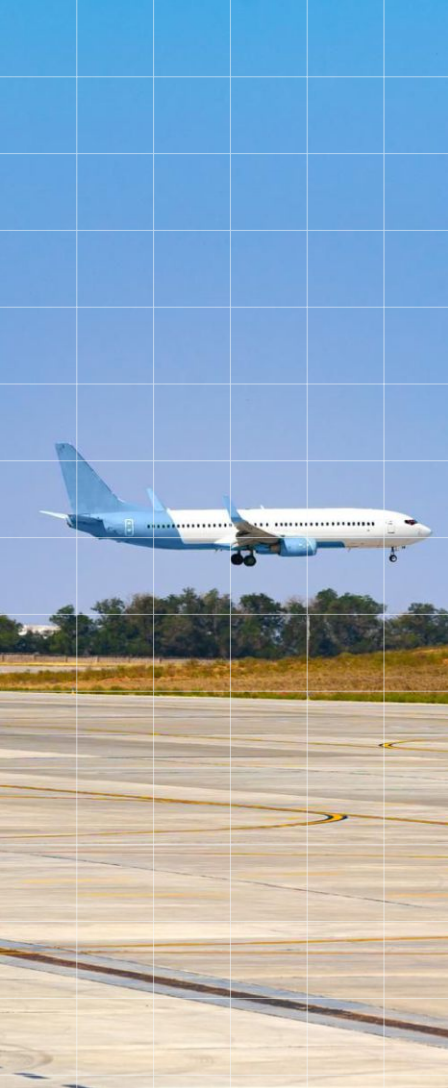

PORTS

Most of the movement of commodities and manufactured goods between countries takes place over the sea, making well-designed and efficient ports critical to a country's industrial growth. The Government of India has recognized the crucial role that ports play in facilitating international trade and commerce, and is actively pursuing the upgradation of the country's existing ports, and the creation of new ones.

Our expertise in the ports sector includes port and terminal feasibility studies, port planning, and container terminal planning and design.

Services

Feasibility Studies

Detailed Project Reports

Independent Engineer (IE) & Lender's Engineer Services (LE)

Construction Supervision/Project Management Consultancy (PMC)

Technical Advisor Services (TA)

Transaction Advisory Services (TAS)

Key Projects

LE for a Solid Cargo Port Terminal Project at Dahej, Gujarat, India

Techno-Economic Feasibility Report for the Development of Port at Astaranga Area in Puri District, Orissa, India

Detailed Design and Project Management Consultant for the construction of RoRo cum General Cargo Berth at Kamarajar Port, Tamilnadu, India

IE and operational Auditor for the construction of Gangavaram Port, Andhra Pradesh, India

Technical advisor for Providing Technical Services for construction of Oil Jetty No.7 at Old Kandla Port, Gujarat, India

Survey of Krishnapatnam Port Co. Ltd., Andhra Pradesh, India

LE for Development of Liquid Cargo Berth EQ-10 at Vizag Port, Andhra Pradesh, India

Consultancy Services for Appointment of Project Management Consultant for the Development of RORO cum General Cargo Berth at Kamarajar Port, Tamilnadu, India

Technical Advisor for providing Technical Services for the work Construction of Oil Jetty No.7 of old Kandla, Gujarat, India

TAS for selection of Port Developer for Nargol and Bhavnagar Ports, Gujarat, India



& WATER RESOURCES & IRRIGATION

In a country where the majority of the population makes a living from agriculture, it is difficult to overstate the importance of irrigation. With changing weather patterns and climatic conditions, agriculture is one of the most affected sectors. Traditional irrigation schemes are no longer enough to provide constant reliable water supply for farmer's needs. From massive lift irrigation projects with tunnels and underground pump houses to modernisation studies of major dams, we have been at the forefront of coming up with innovative designs to meet the ever changing needs of the sector.

We provide consultancy services in the execution of large irrigation and hydropower projects involving the construction of canals, barrages, pipelines and other associated structures.

Services

Feasibility Studies (FS) and Conceptual Designs

Detailed Project Reports (DPR)

Detailed Engineering Services

Design Proof Checking

Construction Supervision/Project Management Consultancy (PMC)

Lender's Engineering Services

Pre-Tender Engineering Services

Key Projects

PMC, PEC & TPI covering Planning, Design Review, Quality Assurance, Monitoring and Supervision Services for 52 no of Barrages and Under Ground Pipeline system (40,000Ha) under WRD, Govt of Odisha, India.

Palamuru Rangareddy Lift Irrigation Scheme-Conducting Detailed survey & Investigations including preparation of designs, drawings and estimates upto Field channels for developing irrigation in 6,26,000 acres under Package-2, 4 & 6 and Detailed Engineering Services for Lift-1 and 4, Telangana, India

Detailed Engineering Services for Kaleshwaram Project: Package-6 (BRAPCSSP) comprising Twin tunnels of 10 m dia, 9.5km length with underground Surge Pool, Pump House, Karimnagar, Telangana, India

Final Designs for Kabuyanada Irrigation Scheme: Design of Dam and Piped Distribution Network including Socio-economic, Agro-economic & Techno-economic studies in Uganda

Concurrent Evaluation Study of Subernarekha Multipurpose Project comprising of 2 Dams, 2 barrages and 8 canal networks to irrigate a Gross Command area of 1,54,000 Ha in Jharkhand, India.

DPR for Comprehensive safety of TB Dam, Remodelling of TBP LLC Main Canal, Hydrographic survey and Sediment Analysis of TB Reservoir, Karnataka, India

Making adequate quantities of clean and safe water available to a rapidly growing population is one of the greatest challenges faced by India's central and state governments and local bodies in this century. At the same time, they must also work to minimize or mitigate the detrimental impact of industrial development and population growth on the environment

Understanding the scope and magnitude of the problem, we have built up significant expertise and experience in these sectors over the years, and are now able to formulate reliable, innovative, sustainable and in some cases, award-winning solutions to these problems. We provide consultancy services in water supply, waste water treatment and water recycling projects, and also offer services in Environmental engineering, risk management and disaster management

We provide consultancy services in water supply, waste water management, treatment and reuse, storm water management and also offer services in Environmental Services like EIA, EMP, Risk management and Disaster Management.

Services

Conceptual Design Reports, Master Plans and Detailed Project Reports (DPR)

Project Management Unit (PMU)

Independent & Authority Engineer Services

Project Development & Management Consultant (PDMC)

Project Management Consultancy (PMC) and Construction Supervision

Third Party Quality Assurance & Control (TPQA&C)

Environmental Services including lake and river conservation studies

Key Projects

Planning, Design, DPR and Bid Document for Comprehensive Storm Water Drainage system for Patna Nagar Nigam, Khagaul, Danapur, Phulwarisharif, Bihar, India

Setting up of a PMU in State Water and Sanitation Mission (SWSM) of 09 Revenue Divisions-Ayodhya, Azamgarh, Basti, Devi Patan, Gorakhpur, Lucknow, Prayagraj, Varanasi and Vindhyachal, Uttar Pradesh, India

PDMC for AMRUT -2.0 in Southern Zone Jabalpur and Shahdol Division's of UADD in Madhya Pradesh, India

PMC to Design, Develop, Manage and Implement Smart City Projects under Smart City Mission in Karimnagar, Telangana, India

Third Party Inspection and Monitoring of Physical and Financial Progress of Rural Water Supply Projects 18 Districts in the state of Uttar Pradesh, India

TPQA&C Consultant for Water supply, Sewerage and Green Space & parks Works taken up under AMRUT in 12 ULBs under Telangana Urban Finance & Infrastructure Development Corporation Ltd. (TUFIDC), Telangana, India



URBAN DESIGN

Increasing urbanisation has led to emphasis on creation of Sustainable Smart Urban Infrastructure. Through our extensive multi-sectorial experience, we are equipped to provide comprehensive solutions to prevalent demands of urban development. We undertake design of new cities and townships from planning to commissioning and give innovative solutions for upgrading existing cities to Smart Cities.

Services

- Concept Design
- Feasibility Study (FS)
- Detailed Project Report (DPR)
- Tender Support
- Detailed Design of Urban Utilities
- Construction Supervision
- Project Management Consultancy (PMC)

Key Projects

DPR and Tender Support for Shendra Industrial Smart City in the Delhi Mumbai Industrial Corridor, DMICDC, Aurangabad, Maharashtra, India

Preparation of first stage proposals for Allahabad Municipal Corporations as a part of Smart City Mission by Ministry of Urban Development, Uttar Pradesh, India

Preparation of first stage proposals for Aligarh Municipal Corporations as a part of Smart City Mission by Ministry of Urban Development, Uttar Pradesh, India

Preparation of Smart Integrated Infrastructure Master Plan and DPR for Phase-I works at Amaravati capital city area (217.00 Sq.km) for APCRDA, Andhra Pradesh, India

Preliminary Design Report for Roads and Services/Utilities and CBD for Phase-I of Shendra – Bidkin Industrail Area, Aurangabad, India

PMC to Design, Develop, Manage and Implement Smart City Projects under Smart City Mission (SCM) in Prayagraj, Uttar Pradesh, India

PMC to Design, Develop, Manage and Implement Smart City Projects under Smart City Mission (SCM) in Karimnagar, Telangana, India

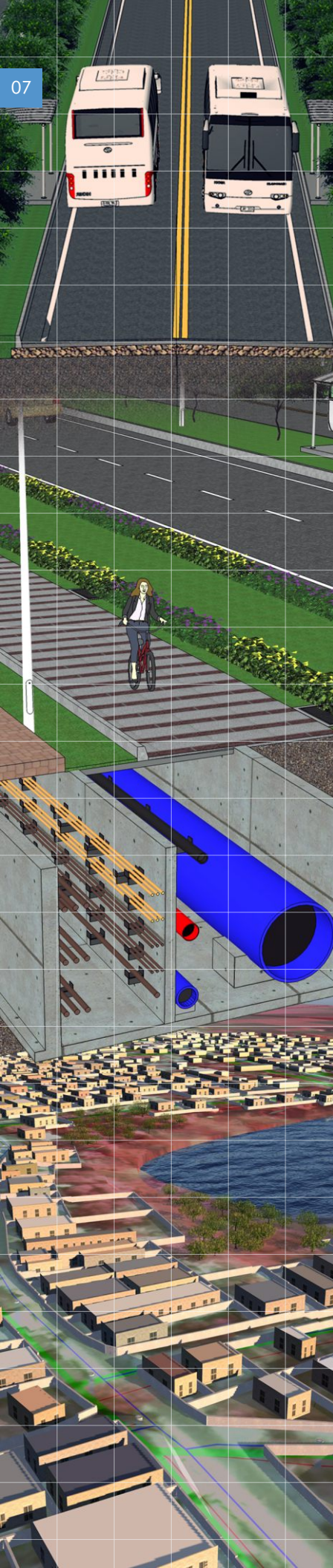

URBAN PLANNING

With more and more people migrating to urban areas, the infrastructure in India's towns and cities is coming under increasing strain. Increasing urbanization also creates its own share of environmental and ecological challenges. In this context, the consultancy services we provide to the central and state governments and various local bodies are critical in ensuring the healthy and well-planned growth of our urban agglomerations.

Our urban planning division offers planning solutions, using the latest geospatial tools and techniques, to meet the basic development requirements of government agencies and urban local bodies.

Services

- GIS based Master Plan / Development Plan
- GIS based Zonal Development Plan (ZDP)
- City Development Plan (CDP)
- Regional Plan & District Development Plan
- Comprehensive Traffic & Transportation Study (CTTS)
- Comprehensive Mobility Plan (CMP)
- Traffic Impact Assessment (TIA)
- Industrial Estate Master Plans

Key Projects

- Detailed Master Plan and Zonal Development Plan for the Andhra Pradesh Capital Region Development Authority (APCRDA) Region (about 8500 sq.kms), the 2nd largest Capital Region Master Plan in India, Andhra Pradesh, India
- Development Plan for Madhava Rao Counter Magnet, Special Development Authority (SADA) area, Gwalior, Madhya Pradesh, India
- Master Plan for Kathua and its 5km vicinity, Jammu Division, Jammu & Kashmir, India
- Master Plan for Kurnool Municipal Corporation Area and its 5km Vicinity, Andhra Pradesh, India
- CDPs for 7 towns in Jabalpur, Katangi Districts, Madhya Pradesh, India
- GIS based Master Plan for Siddipet Urban Development Authority (SUDA), Telangana, India
- GIS based Master Plan for Nizamabad Urban Development Authority (NUDA), Telangana, India
- Perspective Plan, Master Plan and Zonal Development Plan for Nellore Urban Development Authority (NUDA) Region, Andhra Pradesh, India



& ARCHITECTURE & BUILDINGS

Buildings are integral part of the urban environment. At Aarvee, functional requirements are given priority duly addressing environmental concerns while designing every building. We focus on the characteristics of the site, incorporate elements of local architecture and adopt contemporary design principles.

Over the years we have been providing consultancy services for several institutional, residential, industrial, healthcare, sports, entertainment, educational and commercial Sectors. Our work showcases our attention to detail and the importance we give to quality.

Services

Architectural Design	Feasibility Studies (FS)
Structural Design	Detailed Project Reports (DPR)
MEP Design	Pre-Tender Services
BIM Modelling	Detailed Design
Survey & Field Investigation	PMC / CS
Master Planning	Design Proof Checking

Key Projects

Design for International Standard Shooting Range and Rehabilitation of Existing Stadia at Different Locations in Hyderabad, Telangana, India

Design and PMC Services for AC Auditorium at Vizag Port for VPT, Andhra Pradesh, India

Design for IT Incubation Center at Tirupati for APIIC, Andhra Pradesh, IT Tower for TSIIIC In Nalgonda & Ramagundam in Telangana, India

Design for Area Hospitals at Chirala, Kuppam and Guduwada for APMSIDC, Andhra Pradesh, India

Design and PMC services for Academic block and Hostel block for Osmania University, Telangana, India

Master planning and Feasibility Report for Integrated Sports Stadia in Vizag & Tirupati for INCAP, Andhra Pradesh, India

Design Services for 1200 bedded Super Specialty Hospital Telangana Institute of Medical Sciences (TIMS) Alwal, Medchal-Malkajgiri District under BPC mode in Telangana, India

Design services for Nursing College, ITI College and CHC in Telangana for TSMSIDC, Telangana, and APMSIDC For Andhra Pradesh, India

FS, Detailed Master Planning, Urban Designing, Engineering and DPR for Major Upgradation of Vijayawada Railway Station, Andhra Pradesh, India

District Hospitals, Teaching Hospitals, Critical Case Hospitals

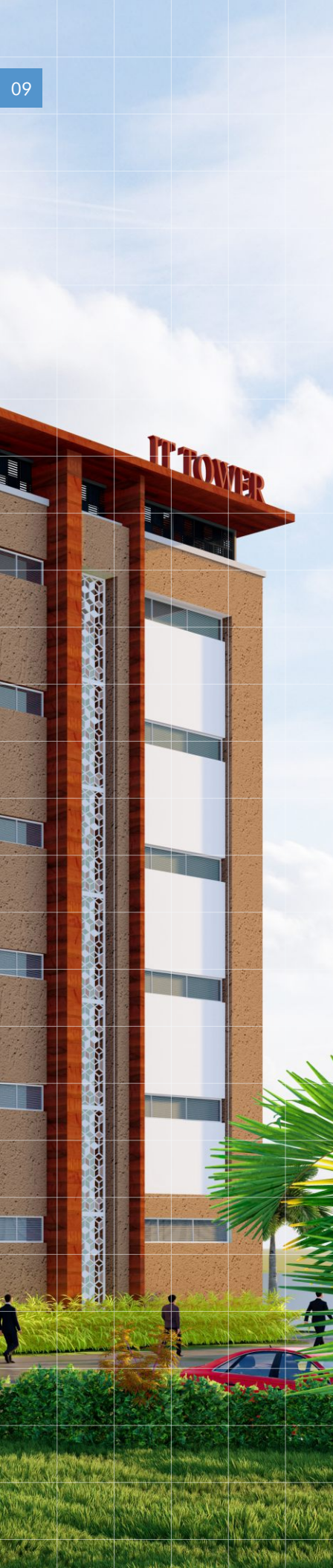

GEOSPATIAL SERVICES

We offer a wide range of geospatial services to both government and private sector clients. Our expertise in the conceptualization, design and development of robust, scalable and customized geospatial solutions has made us a preferred service provider in various engineering verticals.

Services

Interpretation of Satellite Imagery

Creation of Base Maps and Land Use Maps

Development of Web-GIS Applications and Customization of GIS Applications

Digital Photogrammetry

Network Models, Digital Cost Models, TIN and GRID Analysis

Cadastral Mapping and Land Information Systems

3D GIS

Property surveys and Digital Door numbering

Key Projects

GIS Base Maps for 31 ULBs of Visakhapatnam & Rajahmundry Region APMDP, Andhra Pradesh (World Bank Funded), India

District Rural Road Plan (DRRP) in GIS Platform (PMGSY) for five districts of Kerala, India

Integrated Water Supply System Simulation and Design for HMWS&SB, 12 Outer Municipalities, Hyderabad, using GIS, EpaNET and Google Earth Pro, Telangana, India

GIS-based Master Plan for Sri Satya Sai Urban Development Authority, Andhra Pradesh, India

GIS-based Decision Support System for the Nagarjunasagar Command Area including the Left and Right Banks, Andhra Pradesh, India

Conducting detailed Investigation including survey of the entire catchment area of Kondaveeti vagu and its in falling drains in Guntur district, Andhra Pradesh, India

GIS Base maps of 14 Towns of Bihar, India

GIS base map, Revenue database updation survey and Rationalization of House Numbering (Digital Door numbering) 75 ULBs, Andhra Pradesh, India

GIS Basemap preparation and Formulation of GIS-based Master Plan for Cluster 8, West Bengal, India.

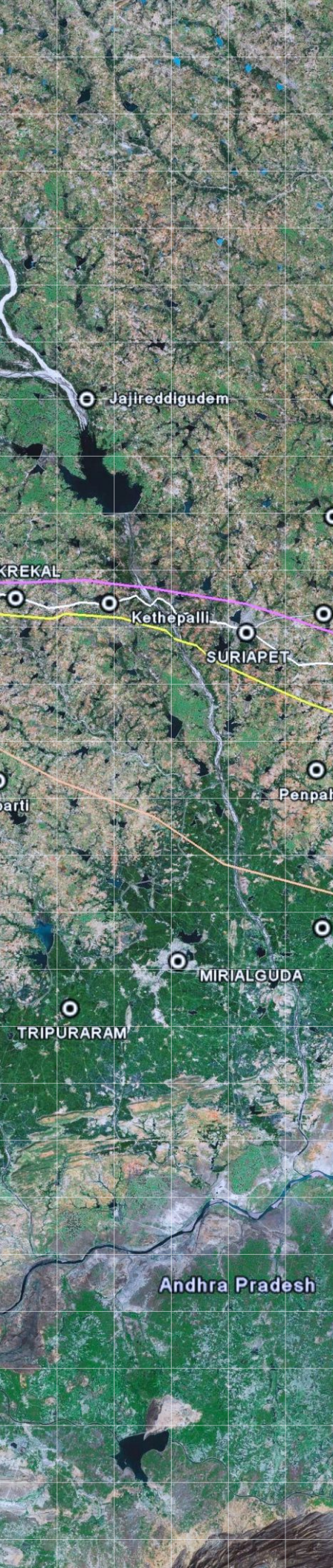

POWER

The energy sector holds the key to accelerating the growth of the Indian economy. Power demand in the country is increasing rapidly due to increasing demand from the Agricultural, Industrial and Infrastructure sectors. To meet this rising demand, the Government of India is facilitating large scale additions to power generating capacity through public and private investments.

We have expertise in conducting Feasibility Studies, preparing Detailed Project Reports and providing Detailed Engineering and Project Management services.

Sectors

Hydro Power	Hydro Pumped Storage
Solar Power	Distribution Network
Thermal Power	Transmission Lines & Substations

Key Projects

Preliminary and Detailed Surveys of about 1200km lengths of Double & Multi circuit Transmission lines and 30km lengths of Pole type distribution lines in the states of Telangana, Andhra Pradesh, Karnataka, Madhya Pradesh, India under TSTRANSCO, APTRANSCO, KPTCL and MPPTCL, India (respectively)

Identification of site, Feasibility study and Detailed Project Reports for establishment of Pumped Storage hydro electric Projects (PSP) and Hydro Power Projects including topographical surveys, Geological & Geo-technical Investigations, Seismic Studies, EIA & EMP Studies, SIA Studies for :

- Pinnapuram PSP (Andhra Pradesh) – 1200MW
- Saundatti PSP (Katakana) – 1260MW
- MP30 Gandhisagar PSP (Madhya Pradesh) – 1440MW
- Chitravathi PSP (Andhra Pradesh) – 500MW
- Yerrvaram PSP (Andhra Pradesh) – 1200MW
- Bhavali PSP (Maharastra) – 1500 MW
- Gujjili PSP (Andhra pradesh) – 1500 MW
- Chittermwalasa PSP (Andhra Pradesh) – 1000 MW
- Vempalli PSP (Andhra Pradesh) – 1500 MW
- Veeraballi PSP (Andhra Pradesh) – 1800 MW
- Ranapur PSP (Telangana) – 1200 MW
- Pane PSP (Maharastra) – 900 MW
- Kandhaura PSP (Uttar Pradesh) – 1200 MW
- Nagarjuna Sagar PSP (Andhra Pradesh) – 240MW
- Upper Sileru PSP (Andhra Pradesh) – 900MW
- Pulichintala HPP (Andhra Pradesh) – 60MW

SURVEY

Reconnaissance survey – Walk through /Inventory

Engineering Survey – Roads, Rail, Irrigation, Power, Water Supply & Sewerage, Buildings

Topographical Survey – Collection of Ground Features / Grid Levels

Catchment Survey – Contours , Ridges and Valleys demarcation

Command area Survey – Grid Levels, Ground Features, Ridges and Valleys demarcation

Cadastral Survey – Land acquisition Survey and Land Parcel mapping

Asset mapping survey - Measurement and Mapping of Physical features

Hydrographic/Bathymetric Survey – River/Reservoirs under water survey

Final Location Survey – Alignment Stakeout

Aerial LiDAR Survey – Roads , Rail, irrigation, Catchment , Command area

Aerial Photography/ Videography by UAV/Aircraft – Corridor mapping, Large scale mapping, Progress monitoring.

Mobile LiDAR Survey – Road, Rail, Telecommunications

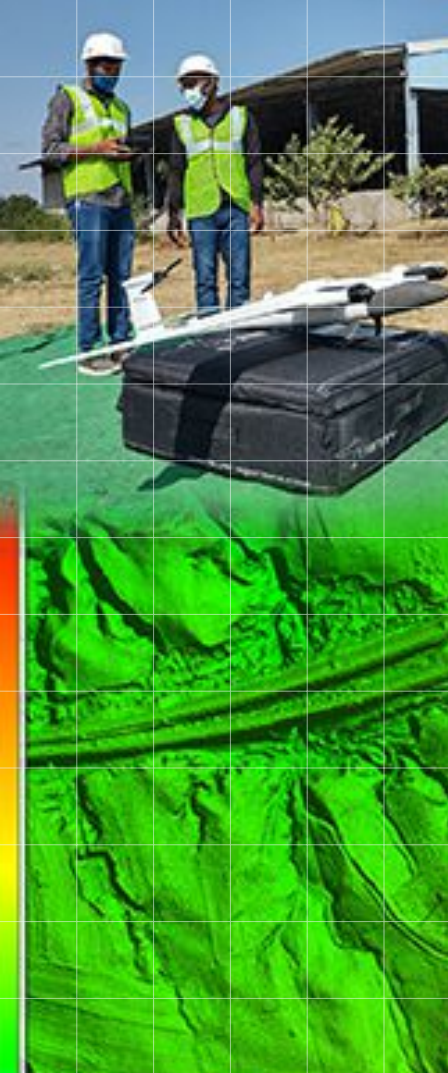

GEOTECHNICAL & MATERIAL TESTING



We have a wide range of testing facilities for Soil, Rock, Cement, Concrete, Coarse & Fine Aggregate, Fly ash and Bitumen, fulfilling most civil engineering requirements including Shear Parameters, Consolidation parameters, Permeability and Swelling characteristics of different types of soil. We also undertake Geophysical Investigations (SRT & MASW) and Ground Penetrating Radar (GPR) for utility engineering purpose are also available.

Field investigations comprising of Pavement Structural Strength using FWD/ BBD; Road Roughness using Fifth-wheel Bump Integrator/Laser Profilometer; Road Geometry, Inventory, Pavement Condition using Network Survey Vehicle (ROMDAS), Retrorefletometer (RRM) for measurement of Reflectivity of Road Signs and Pavement markings; ATCC for classified traffic counts on highways.

All test procedures and techniques adhere to IS, BS, AASHTO & ASTM standards.

EMPANELMENT

We are empaneled with various government and other agencies.

Allahabad Bank	Ministry of Housing & Urban Poverty Alleviation, Govt. of India
Andhra Pradesh Capital Region Development Authority	Maha Metro
Andhra Pradesh Industrial Infrastructure Corporation Limited	Nagpur Improvement Trust
Dedicated Freight Corridor Corporation India Ltd	Odisha Urban Infrastructure Development Fund
Department of Tourism & Culture, Odisha	Odisha Construction Corporation Limited
Department of Urban Development, Housing and Local Self Government, Rajasthan	Osmania University, Hyderabad
Directorate of Urban Administration and Development, Madhya Pradesh	Panchayat Raj Engineering Department, Karnataka
Directorate of Town & Country Planning, Andhra Pradesh	Public Works Department, Maharashtra
Environmental Planning & Coordination Organisation, Madhya Pradesh	Punjab Remote Sensing Centre
EXIM Bank of India	Rail Vikas Nigam Limited
Gujarat Infrastructure Development Board	Rail Land Development Authority (RLDA)
Gujarat Maritime Board	Rural Water Supply & Sanitation, Odisha
Indian Ports Association	State Bank of India
Indian Railways	State Institute of Town Planning, Madhya Pradesh
Irrigation & CAD Department, Andhra Pradesh	Tamil Nadu Infrastructure Development Board
Irrigation & Water Resources Department, Haryana	Tamil Nadu Urban Infrastructure Financial Services Limited
Karnataka Industrial Area Development Board	Telangana State Medical Services & Infrastructure Development Corporation
Karnataka Neeravari Nigam Limited	Telangana State Police Housing Corporation Limited
Madhya Pradesh Jal Nigam Maryadit	Uttarakhand State Infrastructure Development Corporation Limited
Maharashtra Rail Infrastructure Development Limited	Uttar Pradesh State Bridge Corporation Limited
Ministry of Housing & Urban Affairs, Govt. of India	Yadagirigutta Temple Development Authority
Ministry of Urban Development, Govt. of India	Ministry of Urban Development, Govt. of India

GLOBAL PRESENCE



SELECTED CLIENTELE

INDIAN

Adani Group
Andhra Pradesh Capital Regional Development Authority (APCRDA)
Andhra Pradesh Urban Finance & Infrastructure Development Corporation Limited (APUFIDC), Hyderabad
Andhra Pradesh Industrial Infrastructure Corporation (APIIC)
Central Organization for Railway Electrification (CORE)
Central Public Works Department (CPWD), New Delhi
Chhattisgarh Rail Corporation Limited
Dedicated Freight Corridor Corporation of India Limited, New Delhi
Department of Water Resources, Government of Orissa
Directorate of Town and Country planning, Telangana
Directorate of Town and Country Planning, Government of Andhra Pradesh
Greater Hyderabad Municipal Corporation, Hyderabad
Hyderabad Growth Corridor Limited, Hyderabad
Hyderabad Metro Water Supply & Sewerage Board (HMWS&SB), Hyderabad
IRCON International Limited, New Delhi
Irrigation & CAD Department, Government of Andhra Pradesh
Jindal Steel & Power Limited, Orissa
KMC Constructions Limited, Hyderabad
Lucknow Metro Rail Corporation Limited (LMRCL)
Maharashtra Rail Infrastructure Development Limited (MRIDL)
Ministry of Road Transport & Highways (MoRTH), New Delhi
Nagarjuna Construction Company Limited, Hyderabad
National Highways Authority of India (NHAI), New Delhi
Navayuga Engineering Company Limited, Hyderabad
Public Health Engineering Department, Bhopal, Madhya Pradesh
Punjab Land Records Society, Chandigarh
Rail Vikas Nigam Limited, New Delhi
SEW Infrastructure Limited, Hyderabad
Sports Authority of Andhra Pradesh, Vijayawada
Survey Settlements and Land Records, Andhra Pradesh
Tata Projects Limited
Urban Administration and Development Department, Government of Madhya Pradesh

INTERNATIONAL

Administracao Nacional de Estradas (ANE), Mozambique	Fulton Hogan, Australia
Bangladesh Railway	Kenya Railways
Ethiopian Roads Administration	Ministry of Water and Environment, Uganda
Ethiopian Railways Corporation	Tanzania National Roads Agency
Energy Water & Sanitation Authority (EWSA), Rwanda	Uganda National Roads Authority



aarvee associates
architects engineers & consultants pvt. ltd.

An ISO 9001:2008 Certified Company

Ravula Residency, Srinagar Colony Main Rd., Hyderabad-82, India

Tel: +91-40-23737633; 48483456. Fax: +91-40-23736277

e-mail: aarvee@aarvee.net; web: www.aarvee.com